

# Outdoor Trek Retractor

## Product Parts

- 1 - Base
- 2 - Banner Rail (x2)
- 3 - Shock Cord Pole
- 4 - Feet (x2)
- 4a - Buckle
- 5 - Pin (x2)



**\*Do Not Pull Pins Until Directed**



## Banner Install

### Step 1

Remove all of the product parts from the bag and place, along with the banner, on a clean flat surface. Remove both End Caps (A) from the Banner Rail (2) and snap the Banner Rail (2) open. Fully insert the top edge of the Banner into the groove of the Banner Rail (2) and snap it shut. Replace end caps.

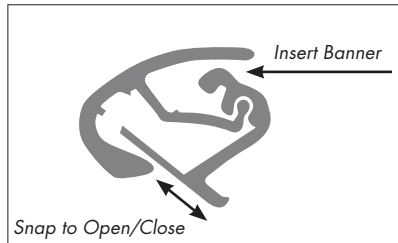

### Step 2

Lay the banner flat, printed side up. On the Base (1) remove the strip of protective paper to expose the adhesive. Press the bottom of the banner onto the adhesive, and to smooth out any bubbles or wrinkles.



### Step 3

Maintain tension on the banner while slowly removing the Pin (4). Allow the banner to gently roll into the canister.



\*Save the pin in the pin holder on the bottom of the Base (1) for future graphic changes.\*



**Repeat steps 1-3 to install a 2nd banner on the other side.**

### Step 4

Once the banner has been fully retracted into the Base, simply place the display in the carrying case until you are ready for display set-up.

## Display Set-Up

### Step 1

Insert the notch on the center of each of the Feet (4) to the receptacles on the bottom of the Base (1).



### Step 2

Slide the inside of the Buckle (4a) into the groove on each side of the Base (1). Press the top of the Buckle (4) down to secure the Feet (4) into place.



### Step 3

Connect the Shock Cord Pole (3) sections together and insert the spring end of the Shock Corded Pole (3) into the pole receptacle on the Base (1).



### Step 4

Stand facing the back of the Base and gently pull the Banner Rail (2) upwards. Connect the back of the Banner Rail (2) into the top of the Shock Cord Pole (3).



## Storage

Place all product parts into Carry Cases and store in a cool dry location.



## Care

To clean, wipe with damp cloth.

# Replacement Graphic

## What you will need before you start

- 1 - Graphic
- 2 - Two-Sided Banner Tape
- 3 - Tension Pin

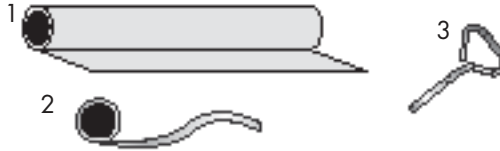

\* For ease of graphic replacement, the use of a competent partner is recommended but not required.



## Prep Instructions

### Step 1

Locate the Tension pin on your retractor. It is usually found on the bottom of the base. A two inch finishing nail can substitute for the pin. Hold the base firmly and have your partner carefully pull the banner completely out of the base exposing the leader beyond the original graphic. This is best done laying the unit on its backside.

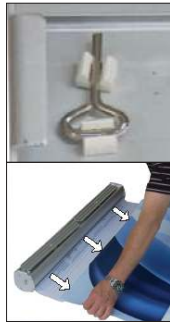

### Step 2

With the leader exposed and tension on the banner, fully insert the tension pin into the hole on the side of the unit preventing the axle from retracting the banner back inside. This may take your partner moving the banner slightly in or out to line the pin in its slot. If done correctly there will not be any tension on the banner and you can begin the graphic change out procedure.

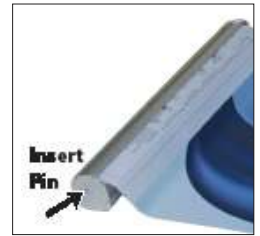

## Graphic Replacement

### Step 1

Carefully peel the graphic from the leader. You don't want to damage or tear the leader.

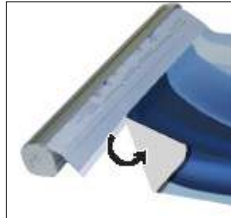

### Step 2

Remove the plastic end caps from the ends of the snap rail. Snap the rail open. Note how the banner was installed in the rail so you can replicate that with the new graphic.



### Step 3

Install the snap rail on the top of the banner. Make sure the banner is all the way inserted in the snap rail. Snap the rail shut and replace the end caps.

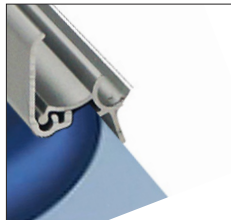

### Step 4

Adhere the provided banner tape to the end of the leader. Remove backer from the tape and adhere the banner to the leader making sure it's completely straight. You can add a strip of packing tape for added precaution.

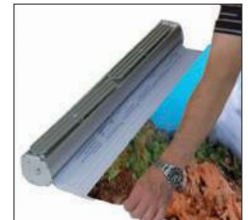

### Step 5

Have your partner hold the top of the banner taut and then gently pull the tension pin out. Retract the new banner slowly into the base.

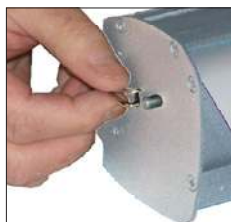

#### NOTE:

End Caps, Snap Rails, Tension Pins and other hardware may vary from your product, however the concept is the same.