

Product Parts for HARDWARE

- 1 - Mural Graphic Face Plates (qty: 24)**
- 2 - Mag Rails (qty: 6)
- 3 - Oval Hard Case
- 4 - Hardware Bag
- 5 - Frame

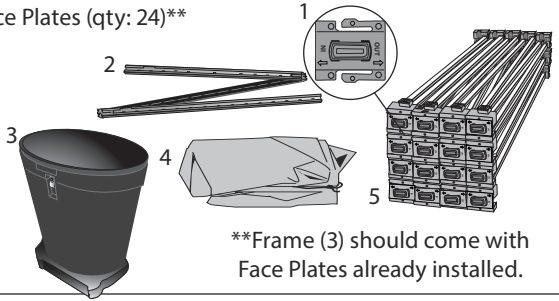

**Frame (3) should come with Face Plates already installed.

9 QUAD FRAME

ALL PARTS
COME
IN THE KIT

TOP VIEW

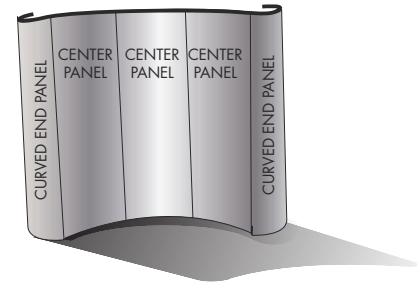
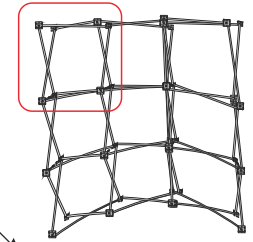

Product Parts for PANEL KITS and LIGHTS

- 6 - Double LED light kit (x2) & Light Adapter
- 7 - Panels (see chart above for qty and panel style)
- 8 - Case to Counter Kit

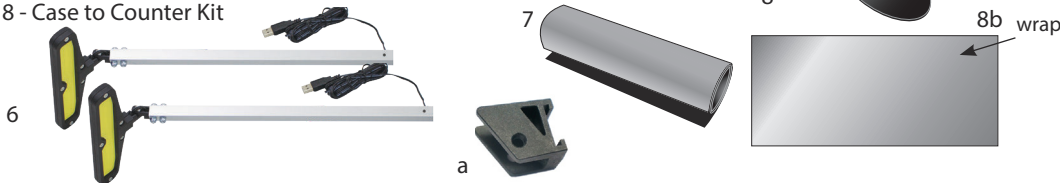

Display Set-Up

Step 1

Remove all parts from your Hard Case (3) and place on a flat, clean surface. Review the Frame (5) and notice where the pivoting light clips are located. This will determine the TOP of the display.

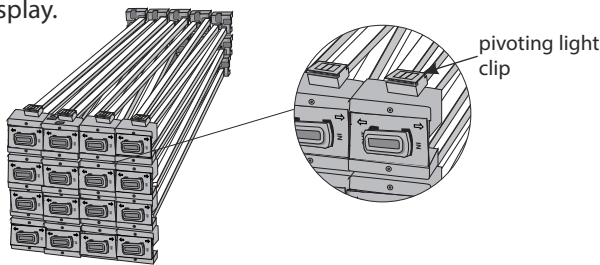

Step 3

Push all locking clips together to secure the Frame (5) in its expanded position.

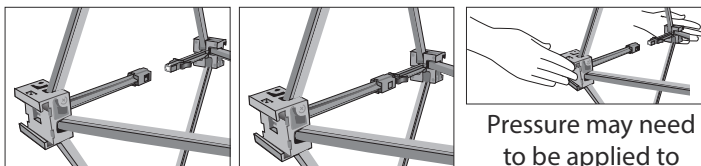

Pressure may need to be applied to secure.

OPEN

CLOSED

Step 2

Pull the Frame (5) up and out from the corners until it is fully expanded on the floor.

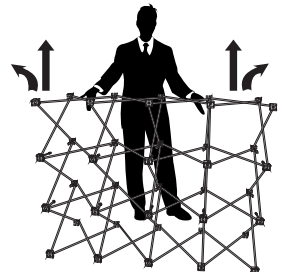

12 Quad shown as example

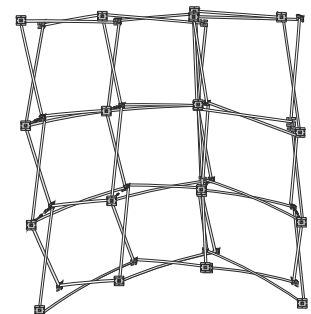

Step 4

With Frame (5) set up and in locked position, you will now be installing all of the Mag Rails (2). Steps 5 thru 9 show how to install the Mag Rails (2) as well as an instructional video:

http://createdisplaysite.com/Mag_Rail_Install.html

Display Set-Up Continued

Step 5:

With 3-sectioned Mag Rail (2) folded, (fold so pins are UP and facing away from the frame) start with BOTTOM section and slide back slot onto Mural Graphic Face Plates (1) on Frame.

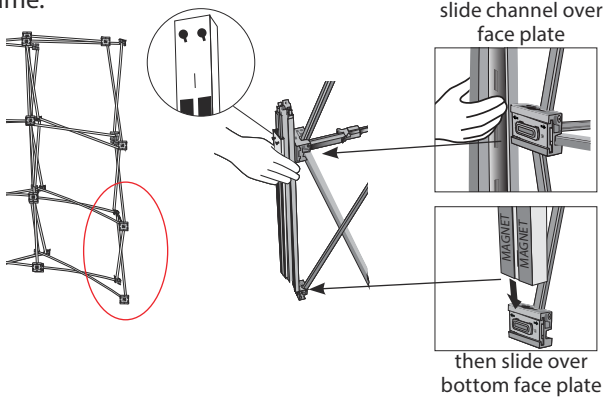

Step 6:

Unfold Mag Rail (2) and fold TOP section onto MIDDLE section. (pins will now be facing the magnets on the middle section)

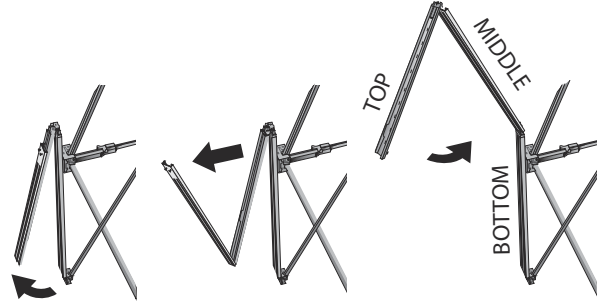

Step 7:

Slide MIDDLE section onto the next upper hub, then interlock to bottom section.

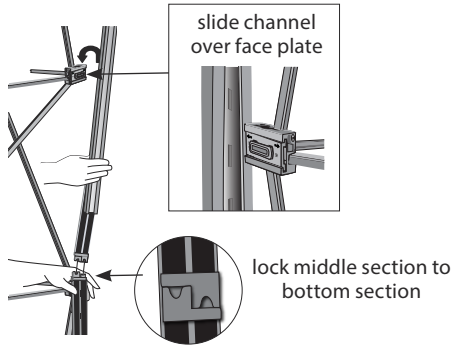

Step 8:

Repeat to secure TOP section of Mag Rail (2) to Frame.

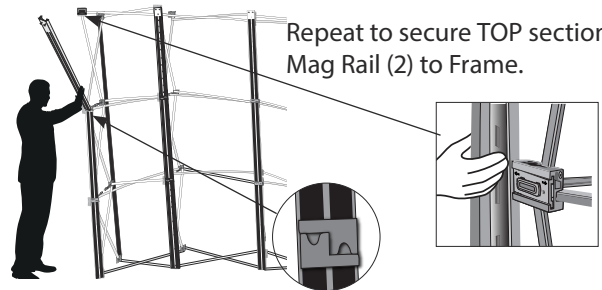

Step 9:

Connect the Mag Rails (2) to the Frame (5) on all front connection points as well as the back vertical ends. Once all Mag Rails (2) are installed give the rails a shake to verify that are all secure.

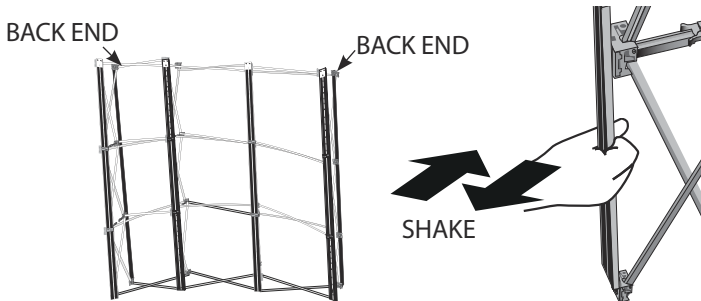

Step 10:

Determine which Mag Rail (2) light (6c) will attach to, and insert clip (6-b) from LED kit (6) into top of Mag Rail (2). Install LED light (6-c) from LED kit (6) onto inserted clip (6-b)

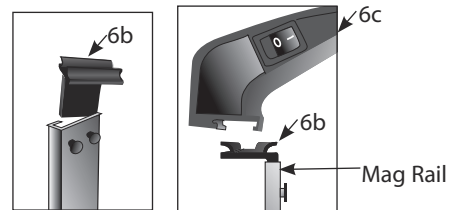

Display Set-Up Continued...

Step 11

Set all plastic wrapped panels (7) out on floor in order of how they will be installed. All panels are installed by hooking the notch located on the top of the panel (7) to the pins at the top of the mag rail (2).

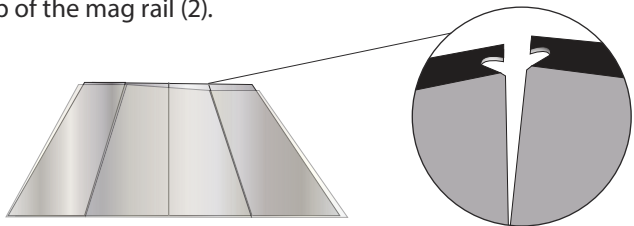

(KEEP the protective sleeves as they will be used for storage.)

Step 12

Install the Panels (7) to the Frame (5). Start with the end panel. Remove it from protective sleeve, and while holding it in a curved position, hook the notches over the pins at the top of front end and back end Mag Rail. With top notches secure, slide your hands down each side of the curved end panel securing it to the vertical Magnets.

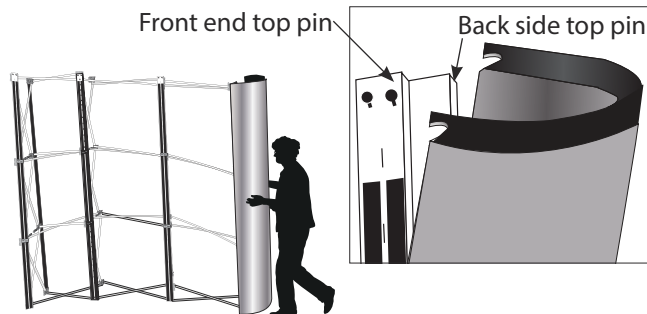

Step 13

Secure the rest of the panels using the same method as in Step 8.



Step 14

Plug lights (6) into power source. Display is now ready.

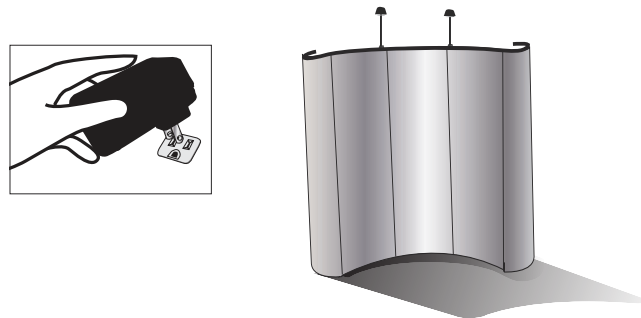

Step 15

Secure Wrap (8b) to the Oval Case (3). Velcro® connection point will be on the backside of Case (3).

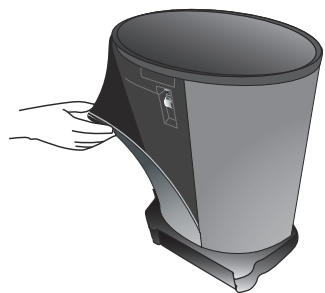

Step 16

Place the oval Top (8a) part of the Case to Counter Kit (8) in the groove on top of the Oval Case (3)

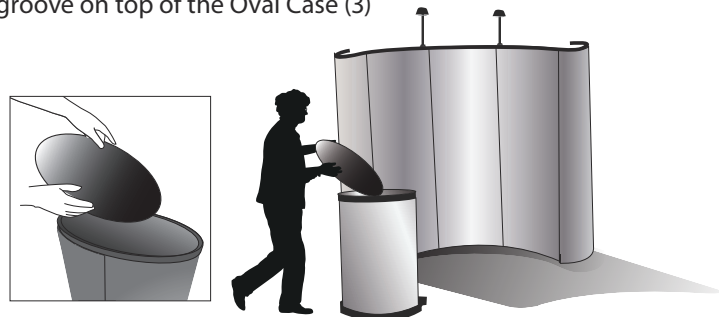

Disassembly Instructions

Step 1

Remove all Panels (7) and carefully roll them up graphic/fabric side out. Place into clear protective sleeves.

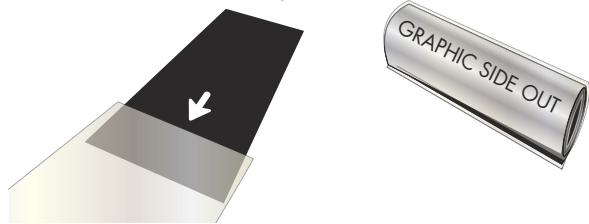

Step 2

Place rolled Panels (7) into Oval Hard Case (3).



Step 3

Unplug and remove lights (6c) and clips (6b) from Frame (5). Place in carrying case.



Step 4

Remove all Mag Rails (2) from Frame (5). Collapse and place in hardware bag (4).

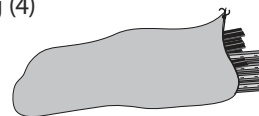

Step 5

Collapse Frame (5). **MAKE SURE ALL LOCKING CLIPS ARE IN OPEN POSITION** before collapsing Frame (5)

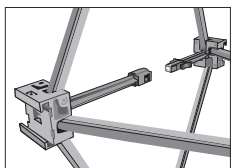

OPEN

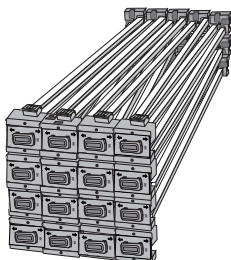

SET-UP NOTE:

Display should have Face Plates (1) already installed in Frame (5). If not, slide, with force, the Mural Graphic Face Plates (1) onto all front hubs and vertical back ends.

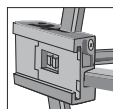
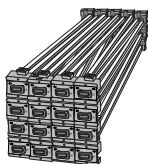

HUB

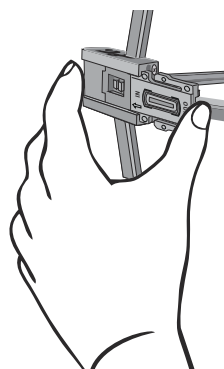

MURAL GRAPHICS FACE PLATE LOCATION

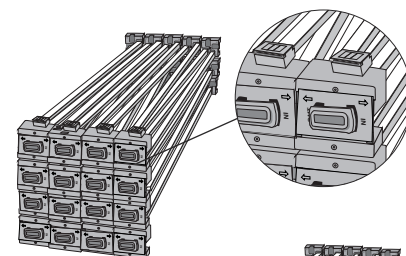

FRONT VIEW

face plates on all FRONT hubs and vertical ends on BACK hubs.

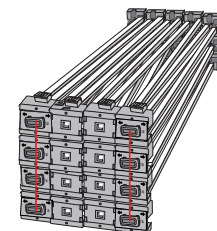

NOTE: FRAME HARDWARE HAS HUBS THAT CAN BE INTERCHANGED TO DISPLAY OTHER PRODUCTS
Conversion kits sold separately-contact client services for more details